

	Description	Order	Part No.	
1	Top Cover Assembly w/Screws	1	HFG689	
	Top Cover	2	H-35025D	
	Top Cover Screw (M5 x .8 x 12MM)	2	HFS1060	
	Bottom Flange Assembly w/Screws	1	HFG690	
	Flange	2	H-35465C	
	Bottom Flange Screw (M5 x .8 x 12MM)	2	HFS1060	
2	Guard Assembly	1	HFG691	
	Guard Set	2	H-33758E	
	Guard Screw (M8 x 1.25 x 50MM SHCS)	2	HFS873	
3	Torque Tube Assembly	1	HFG929	
	1 Clamp	1	H-42967	
	2 Clamp Screw (M8 x 1.25 x 25MM SHCS)	4	HFS1107	
	Hub Assembly (3/4")		1	HFG925
	1 Cotter Pin (5/32" x 1.250")	4	HFS203	
2 Clevis Pin (3/4" x 1.766")	4	H-42403		
3 Bearing Cap w/Insert	2	HFG935		
A Bearing Cap	1	H-44674		
B IGUS® Bushing	1	HCP1684		
4 Socket Head Cap Screws (M6 x 1 x 12MM)	4	HFS876		
Ball Plug	5	H-38168		
Torlon® Ball Bearing (1/2")	27	MP-128		
Delrin® Ball Bearing (1/2")	128	MP-116		
5 Deck Flange	1	H-44680		
4	Hub Assembly (7/8")		1	HFG926
	1 Cotter Pin (5/32" x 1.250")	4	HFS203	
	2 Clevis Pin (7/8" x 1.958")	4	H-42404	
	3 Bearing Cap w/Insert	2	HFG935	
	A Bearing Cap	1	H-44674	
B IGUS® Bushing	1	HCP1684		
4 Socket Head Cap Screws (M6 x 1 x 12MM)	4	HFS876		
Ball Plug	5	H-38168		
Torlon® Ball Bearing (1/2")	27	MP-128		
Delrin® Ball Bearing (1/2")	128	MP-116		
5 Deck Flange	1	H-44680		

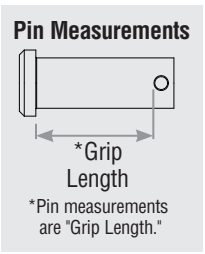

No.	Description	Order	Part No.
5	Rod Adapter Stud (-22) w/Nosepiece	1	7426 -22
	1 Stud (Main Body)	1	H-41812
	2 Nosepiece (-22)	1	H-41811
	3 Cotter Pin (5/32" x 1 3/4")	2	HFG319
4 Stud Cap (7/8" ID (not shown))	1	HFG303	
	Rod Adapter Stud (-30) w/Nosepiece	1	7427 -30
	1 Stud (Main Body) (not shown)	1	H-41814
	2 Nosepiece (-30)	1	H-41813
	3 Cotter Pin (5/32" x 1 3/4")	2	HFG319
4 Stud Cap (7/8" ID (not shown))	1	HFG303	

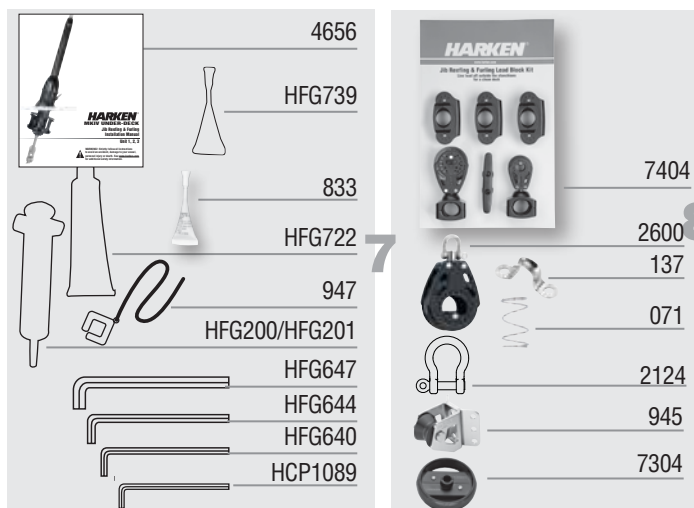
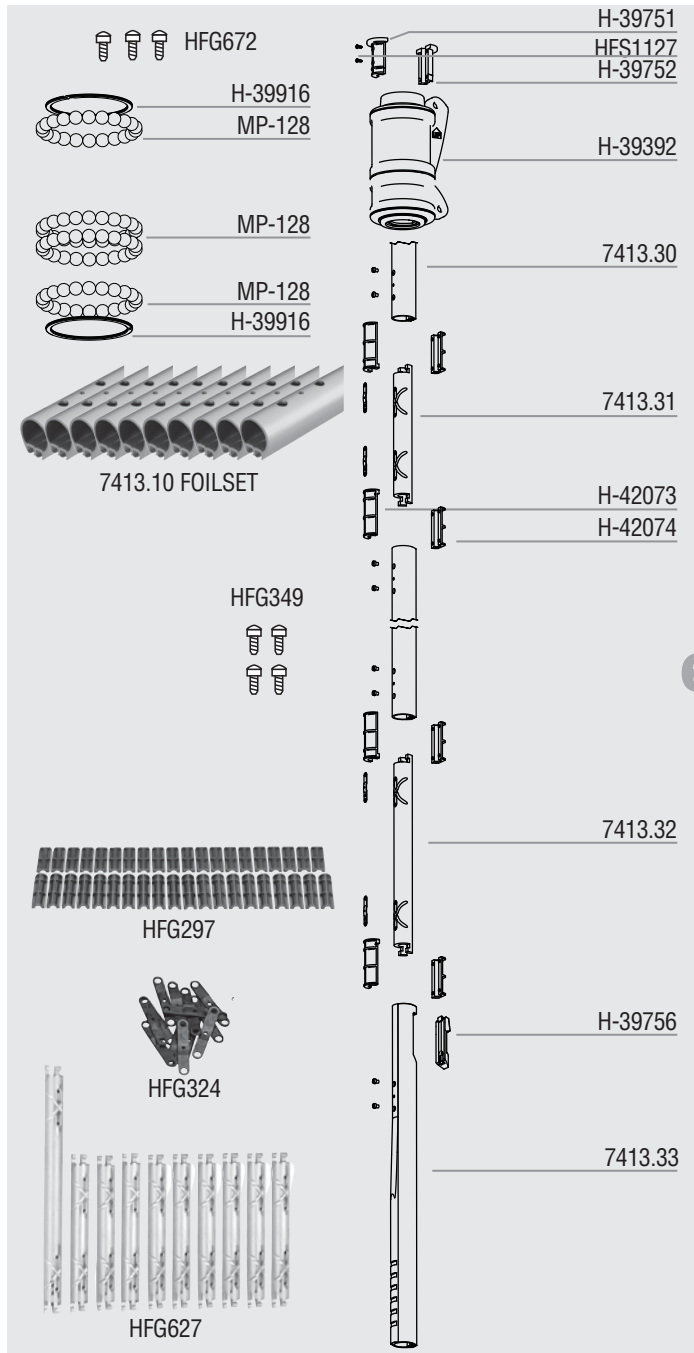

6

Description	Order	Part No. (3/4, 7/8)
Trim Cap		
Top (with Holes)	1	H-39751
Bottom (with Pegs)	1	H-39752
Trim Cap Screw Set	1	HFG672
Trim Cap Screw	3	HFS1127
Halyard Swivel w/o Shackles	1	H-39392
Torlon® Ball Bearings	88	MP-128
Clip/Smalley Ring	2	H-39916
Foil Set	1	7413.10 FOILSET
Foil (7' / 2.13 m) Luff	10	7413.30
Foil (2"/610 mm) Bottom	1	7413.33
Foil Screw Set	1	HFG349
Foil Screw	46	HFS1106
Connector Set	1	HFG627
Connector (9 ³ / ₄ " / 248 mm)	9	7413.31
Bottom Connector (14" / 356 mm)	1	7413.32
Connector Bushing Set	1	HFG297
Connector Bushing Top (Curved / Longer)	20	H-42073
Connector Bushing Bottom (Flat / Shorter)	20	H-42074
Connector Wedge Set	1	HFG324
Connector Wedge	22	H-39487
Feeder with Screw and Tab	1	H-39756
Feeder	1	H-38332B
Feeder Screw	1	HFS1130
Tab	1	H-38372A

7

Description	Order	Part No. (3/4, 7/8)
Instruction Manual	1	4656
Prefeeder	1	947
Loctite® Blue	1	833
Loctite® Red	2	HFG739
5200 Adhesive Set	1	HFG725
5200 Marine Adhesive Sealant	1	HFG722
Injector	1	HFG200 HFG201
Hex Keys		
10 mm	1	HFG647
6 mm	1	HFG644
4 mm	1	HFG640
3 mm	1	HCP1089

8

Description	Order	Part No.
Lead Block Kit	1	7404
29 mm Outboard Lead Assembly	3	7403
57 mm Carbo Ratchet Assembly	1	7402
40 mm Carbo Assembly	1	7401
Horn Cleat	1	HCP168
Additional Lead Blocks		
57 mm Carbo Single Swivel	1	2600
Stainless Steel Eyestraps	1	137
Stand-Up Spring	1	071
Thru-Deck (2.25") (not shown)	1	HC7981
Shackle (10 mm)	3	2124
Halyard Restrainer	1	945
Sheave/SS Inner Race Only	1	945ASSY
Clevis Pin (5/16" x 1 1/4")	1	SP-038
Bracket-Large	1	HCP394
Cotter Pin (3/32" x 3/4")	1	HFS181
Halyard Deflector	1	7304